



Quick Guide

icare

iCare ST500 tonometer system

The iCare ST500 tonometer system consists of the tonometer (TA04), cradle (TX02), remote control (TR01) and slit lamp adapter (TD01).

The iCare ST500 tonometer is a slit lamp tonometer based on the iCare rebound technology, which is compatible with most of the common slit lamp models on the market.

The ST500 SmartCradle is used to store the tonometer and accessories between uses and to charge the tonometer's battery.

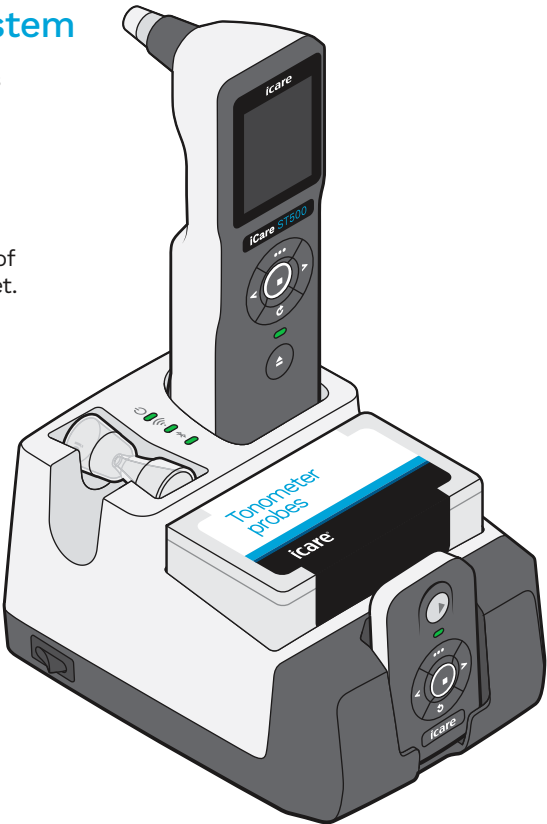

Parts of the tonometer

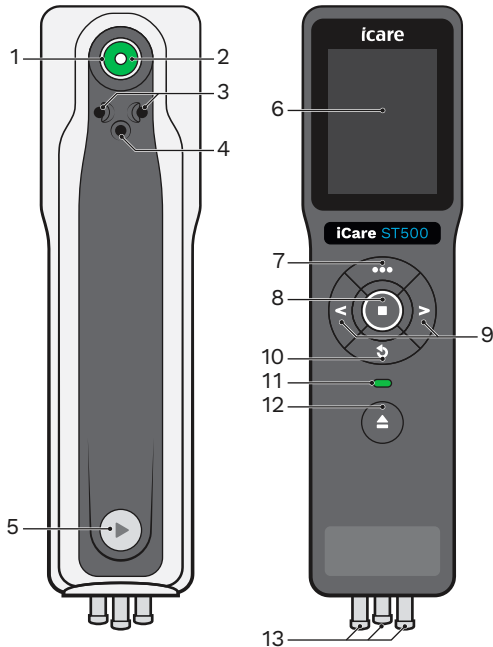

- 1. Probe base collar
- 2. Probe base light
- 3. Infrared LED transmitters
- 4. Infrared LED sensor
- 5. Measure button
- 6. Display
- 7. Option button
- 8. Select button
- 9. Navigation buttons
- 10. Return button
- 11. Status indicator light
- 12. Eject button
- 13. Mounting pins

Charge the tonometer battery

Charge the tonometer battery before taking a measurement. The tonometer's battery is charged in the cradle.

To charge the battery:

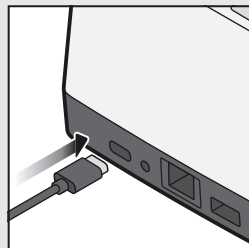

1. Make sure that the cradle is connected to a power supply and turned on.
2. Place the tonometer to the cradle. The tonometer's status indicator starts to flash.
3. The status indicator light turns off when the battery is full.
4. Remove the device from the cradle.



Switch on the tonometer

Lift the tonometer from the cradle. The tonometer will turn on.

To turn on the tonometer manually:

1. Press  for 2 seconds. The device display turns on.
2. Press  again to enter the measurement mode. The text **LOAD** is shown on the display.

Alternatively, press  for 2 seconds. The device display turns on and the text **LOAD** is shown on the display.

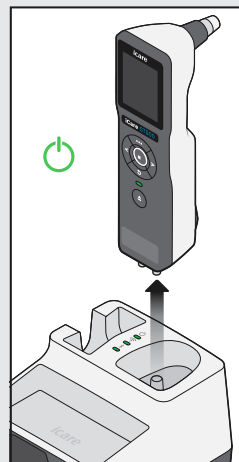

Attach the adapter to the slit lamp

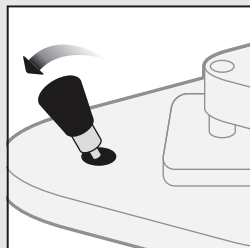

Step 1.

Move the slit lamp away from the head rest.

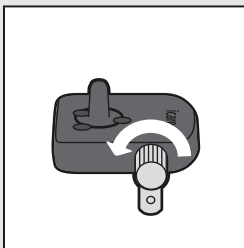

Step 2.

Loosen the adapter screw.

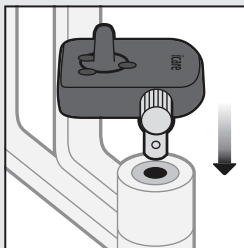

Step 3.

Put the adapter to the rotation axis of the slit lamp and push it down.

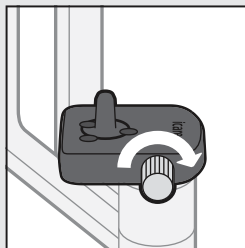

Step 4.

Tighten the screw.

Insert the probe

Without the probe applicator

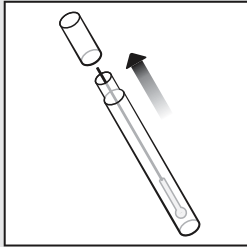

Step 1.

Remove the probe container cap. Do not discard the container.

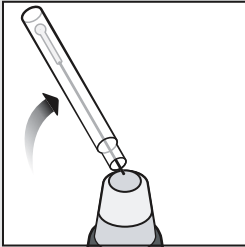

Step 2.

Drop the probe into the probe base.

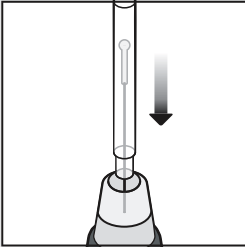

Step 3.

When the probe is successfully loaded, the light indicator in the probe base stops pulsating.

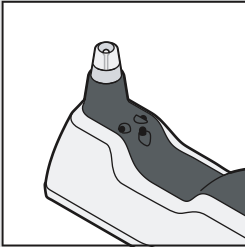

Step 4.

The tonometer is ready to be attached to the slit lamp.

With the probe applicator

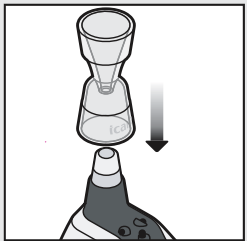

Step 1.

Put the tonometer on a table.

Put the probe applicator on the tonometer.

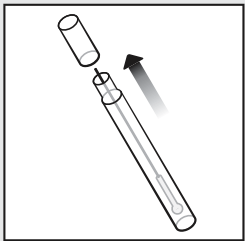

Step 2.

Remove the probe container cap. Do not discard the container.

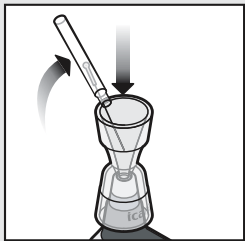

Step 3.

Drop the probe to the applicator.

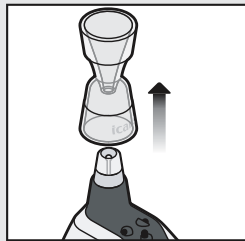

Step 4.

When the probe is successfully loaded, the light indicator in the probe base stops pulsating.

Remove the probe applicator.

Attach the tonometer to the slit lamp

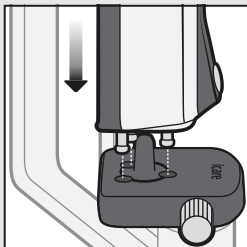

Step 1.

Make sure that the tonometer mounting pins are aligned with the adapter (two in the back, one in the front).

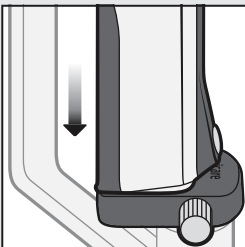

Step 2.

Push the tonometer mounting pins into the holes in the adapter. The tonometer clicks into place.

Correct measurement position

Step 1.

Ask the patient to put their face to the headrest. Move the tonometer in front of the eye that you want to measure.

The probe base light is green when the tonometer's angle is correct (± 10 degrees from the horizontal axis).

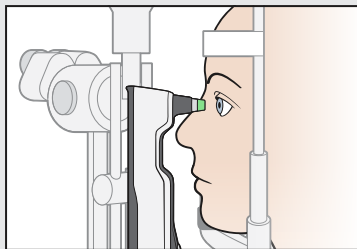

Step 2.

Adjust the height of the slit lamp.

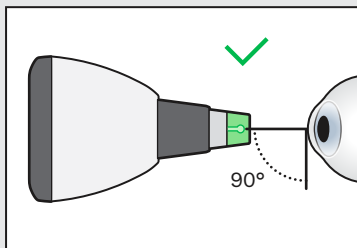
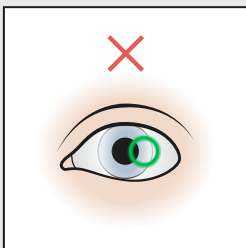
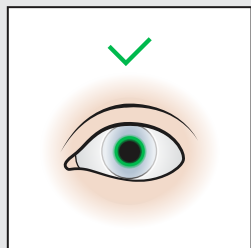

View from above

Step 3.

Make sure that the probe is perpendicular to the center of the patient's cornea.

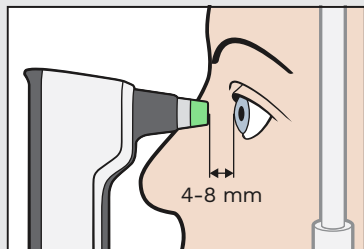

Step 4.

Adjust the distance between the tip of the probe and the patient's cornea. The distance should be 4-8 mm.

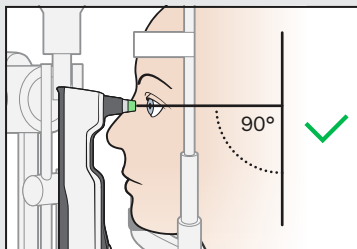



Step 5.

Lock the slit lamp when it is in the correct position.



WARNING! The probe base collar must not touch the eye.

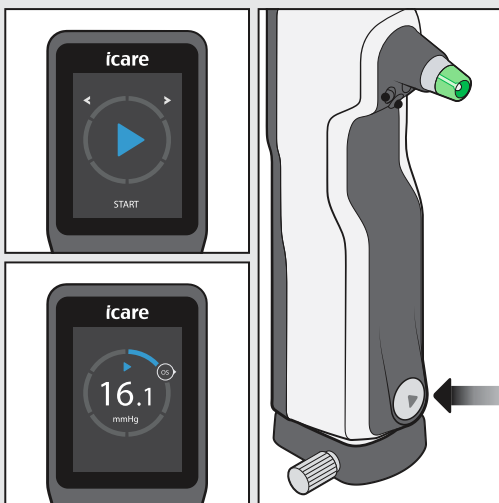

Take a measurement

1. Press  on the device.
2. Take six measurements by pressing  6 times (Single mode) or by holding  down until it has taken 6 measurements (Series mode).



3. When all six measurements have been taken, you hear a longer beep. You can see the result on the display. After a moment the display moves to **Session history**.
4. Move the slit lamp away from the patient before positioning it before the other eye. Press  to measure the other eye.



5. When you want to end the measurement session, press  and then  until you see **END SESSION**. Press  to end the session.



NOTE! You can also see **END SESSION** by pressing .

If you hear two beeps during a measurement, there has been a measurement error. Press  to acknowledge the error and continue measuring.

See the iCare ST500 Instruction Manual for further information on the error messages and corrective actions.



The tonometer includes automatic eye recognition to identify which eye, right or left, you are measuring.

If the automatic eye recognition does not recognize the eye, you can choose the correct eye after the measurement by pressing  to choose the eye (right or left). Press  to confirm the eye.

Check the measurement result



Good measurement quality.



Acceptable measurement quality.



The variation between the measurements was too high. Repeat the measurement.



Session history shows the IOP result in mmHg, the time of the measurement, which eye (right or left) was measured, and the quality of the measurement.

Eject the probe and switch off the tonometer

When you have completed the session, remove the tonometer from the slit lamp adapter and eject the probe.

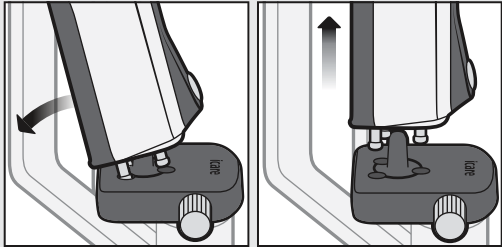

Tilt the tonometer backwards and pull up.

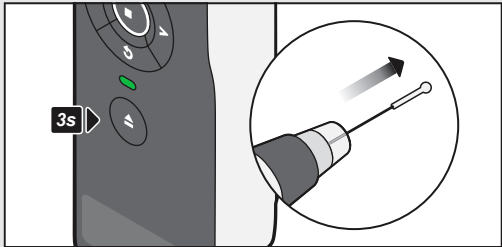

Press for 3 seconds to eject the probe.
Press for 3 seconds to switch off the tonometer.

Put the used probe back into the container. Dispose of the probe and container in a mixed waste bin.



Icare Finland Oy

Äyritie 22

01510 Vantaa, Finland

Ph. +358 9 8775 1150

info@icare-world.com



For further information,
read the instruction manual.



www.icare-world.com/ifu

www.icare-world.com

icare

CE 0598

iCare is a trademark of Icare Finland Oy. Icare Finland Oy, Icare USA, Inc., iCare World Australia Pty Ltd and Centervue S.p.A., are parts of Revenio Group and represent the brand iCare. iCare ST500 is a trademark or a registered trademark of Icare Finland Oy in the EU and the USA and/or other countries. Not all products, accessories, services or offers are approved in every market. Approved labelling and instructions may vary from one country to another. This material is intended for healthcare professionals only. © 2024 Icare Finland Oy. All rights reserved.